

PLAN PLATFORMA PENTRU REZERVOR sc1:50

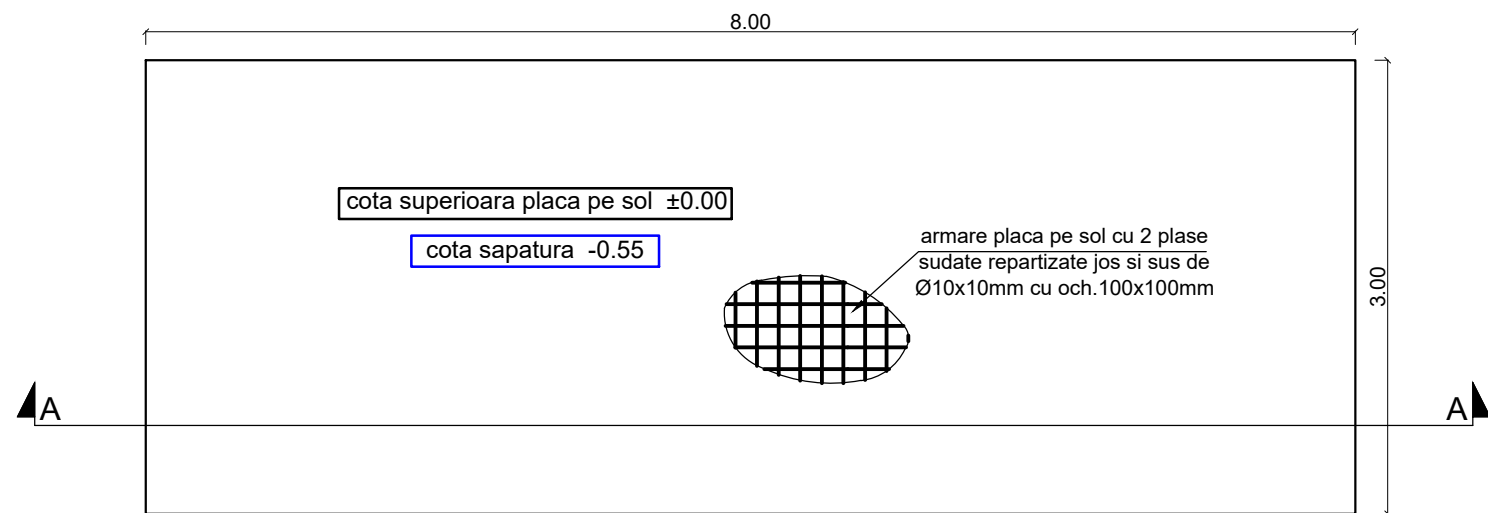

SECTIUNE A-A PRIN PLATFORMA PENTRU REZERVOR sc1:50

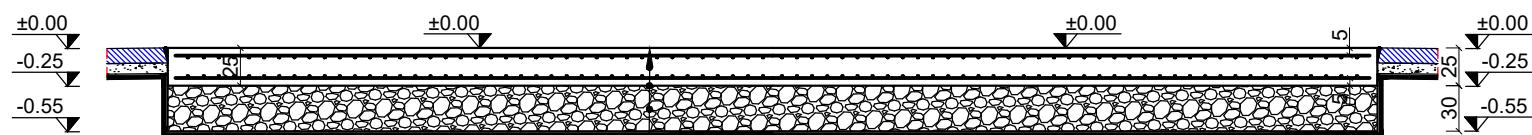

Placa b.a. C25/30 - 25cm armata cu
plasa sudata de Ø10mm cu och.100x100mm - sus si jos
Strat separator(hartie KRAFT sau folie)
Balast compactat mecanizat 30cm

PLAN ARMARE INFERIOARA PLATFORMA sc1:50

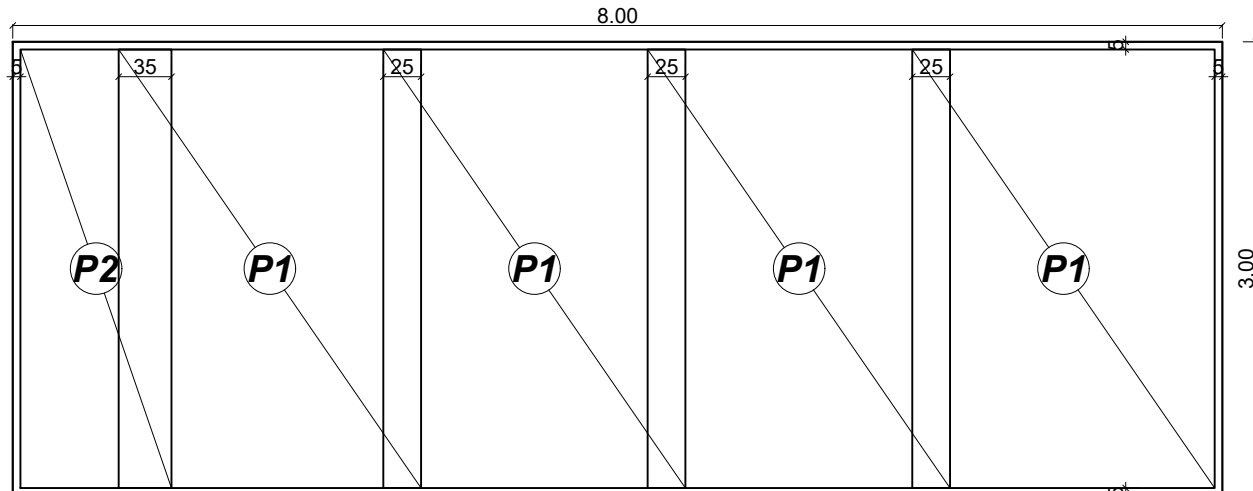

PLAN ARMARE SUPERIOARA PLATFORMA sc1:50

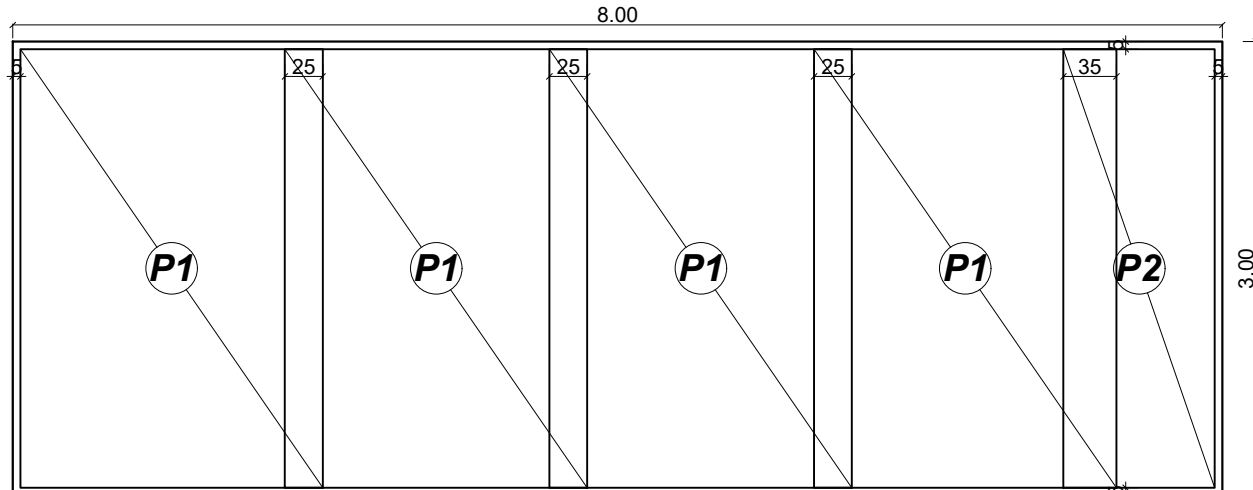

DETALIU TAIERE PLASA 6x2m Ø10 ochiuri 100x100 sc1:50

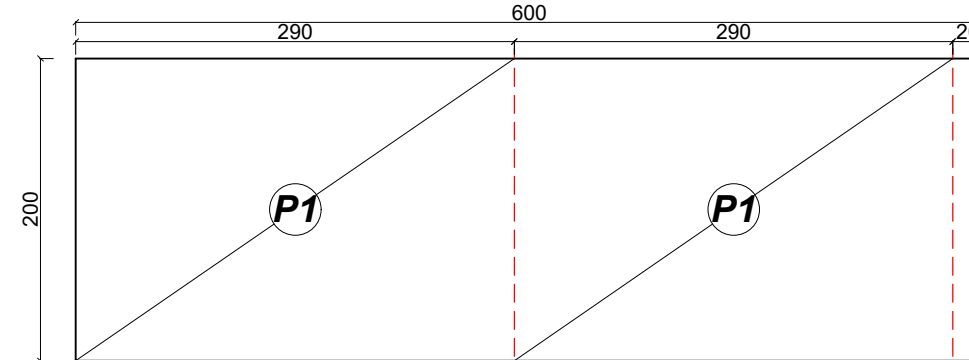

DETALIU TAIERE PLASA 6x2m Ø10 ochiuri 100x100 sc1:50

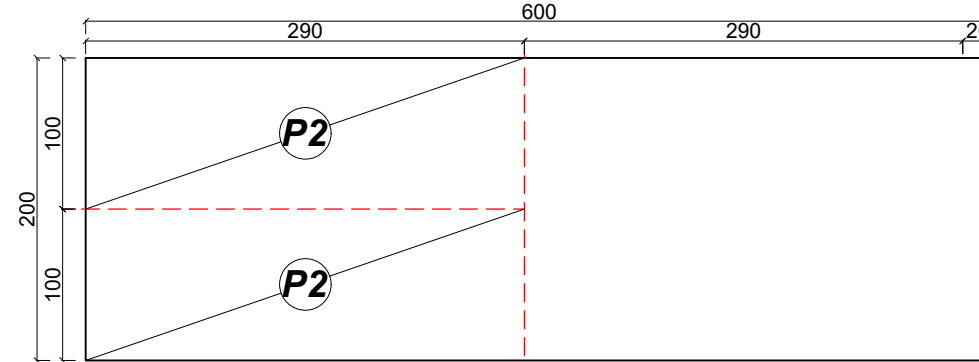

P1 -8buc

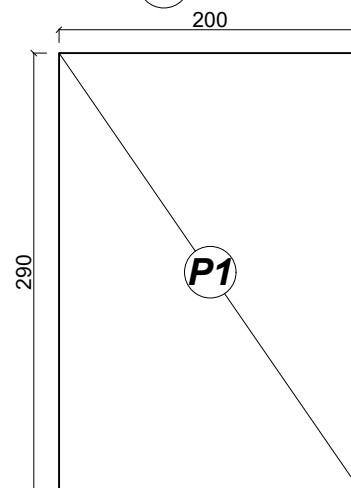

P2 -2buc

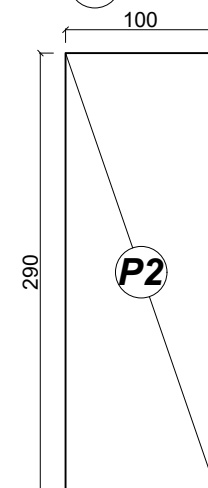

① Ø12 L=1.05m
capre (3 buc/mp)

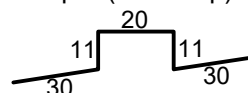

EXTRAS de PLASA SUDATA

Se vor folosi:
Pentru platforma de beton pentru rezervor :
-5 buc. plase sudate Ø10x10 cu ochiuri de 100x100mm de 6x2.00m
G=5x130=650.00kg;

EXTRAS de DISTANTIERI

Se vor folosi:
Pentru platforma de beton pentru rezervor :
-75 buc. distantieri Ø12 cu L=1.05m
G=75*1.05*0.888=69.93kg;

VOLUM de BETON in PLATFORMA:

Se vor folosi:
- 6 mc beton C25/30 in platforma de b.a.

MATERIALE:

Beton-CLASA: -C25/30 - in platforme.
XC4, XF4; -RO; S3 ; CI020; CEM II/A-S32.5R/0-16 mm
- raport A/C max. 0.60, aditivat cu reductori de
apa super plastifianti si antrenori de aer.
Otel -PC 52
Acoperirea cu beton : Cnom=50mm
Suprapunerea plaselor : min. 2.5 ochiuri

NOTA:

- distantierii dintre armatura de la partea inferioara si cea de la partea superioara a placii pe umplutura (caprele) sunt detaliate mai sus si se monteaza in numar de 3 buc/mp .

Verificator	Nume:	Semnatura	Cerinta A	Referat/Expertiza nr. /Data
S.C. VIACONS ART S.R.L-D TEL:0756614911 e-mail: andrei.vekony@gmail.com				Beneficiar: Municipiul Beius Spitalul Municipal Beius
Sef proiect	arh. Marginean Adela		Scara 1:50	Proiect nr.: 22/2019
Proiectat	ing. Vekony Andrei		Elaborat 03. 2019	Faza: PT+DTAC
Intocmit	ing. Vekony Andrei		Listat 03.2019	Titlu planşa: PLAN ARMARE PLATFORMA REZERVOR
				Plansa nr.: 1/R